

SPINNING REEL — PM1655

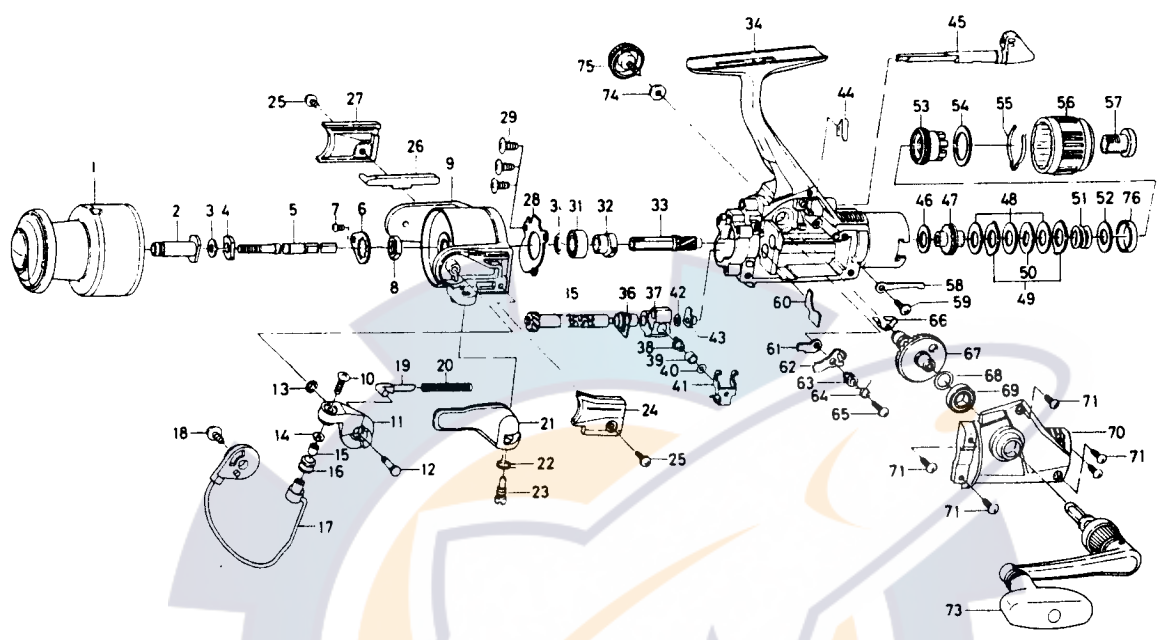

Key No.	Part No.	Part Name	Price
1	F10-9302	Spool assembly	11.50
2	E48-4001	Spool metal	2.80
3	375-3002	Spool washer	.45
4	E18-8801	Main shaft washer	.95
5	E48-3001	Main shaft	3.70
6	B66-2601	Rotor nut holding plate	1.10
7	B93-3001	Rotor nut holding plate screw	.45
8	B10-5701	Rotor nut	.65
9	F01-1506	Rotor	6.40
10	B67-9304	Line roller screw	.40
11	E36-9501	Bail arm	1.65
12	E36-9601	Bail arm screw	1.40
13	320-5901	Bail arm screw retainer	.50
14	B55-4301	Line roller washer	.40
15	B45-1501	Line roller bushing	.60
16	250-3921	Line roller	.90
17	F10-9601	Bail assembly	4.65
18	E00-7101	Bail trip cam screw	.45
19	E36-4401	Bail spring shaft	.70
20	E51-4401	Bail spring	.70
21	E36-9801	Trigger lever	2.70
22	E36-9901	Trigger spring	.70
23	E41-7801	Trigger screw	1.15
24	F01-1702	Bail spring cover	1.65
25	E36-4202	Bail spring cover screw	.60
26	F01-1602	Bail trip lever	1.70
27	E37-8206	Bail trip cover	1.90
28	E48-2901	Bearing retainer	.70
29	E03-7801	Bearing retainer screw	.60
30	371-2827	Bearing washer	.60
31	B54-6001	Ball bearing A	7.70
32	E40-1001	Anti-reverse ratchet	1.10
33	E48-4101	Pinion gear	7.50
34	F10-9401	Body assembly	19.85
35	F10-3601	Worm shaft	8.60
36	E48-2701	Worm shaft bush	.95
37	F10-5101	Oscillating slider	3.20
38	E19-1202	Oscillating pawl	4.55

Key No.	Part No.	Part Name	Price
39	E19-1301	Oscillating pawl bush	3.10
40	375-0800	Oscillating pawl washer	.40
41	F10-5201	Oscillating slider cover	1.40
42	B53-6100	Worm shaft washer	.35
43	F05-6901	Worm shaft collar	.95
44	E26-8701	Anti-reverse cam spring	.60
45	F05-9905	Anti-reverse lever	1.40
46	B46-9505	Drag washer A	.45
47	E48-3201	Click gear	1.70
48	E14-3301	Drag washer B	.65
49	B83-9501	Eared washer	.55
50	E02-4401	Key washer	.60
51	B98-2901	Drag coil spring	.70
52	B27-0703	Drag screw washer A	.60
53	E48-3301	Drag screw	2.95
54	F12-0601	Drag screw washer B	.90
55	F13-6701	Drag washer spring	.70
56	F10-3702	Drag knob	3.00
57	F05-7801	Drag knob screw	1.45
58	E48-3101	Click leaf spring	1.15
59	E36-4202	Click leaf spring screw	.60
60	E48-2801	Shield plate	.70
61	B96-5301	Anti-reverse pawl plate	.75
62	E27-7002	Anti-reverse pawl	1.10
63	B96-5501	Anti-reverse pawl collar	.95
64	B96-5601	Anti-reverse pawl spring A	.70
65	B00-9701	Anti-reverse pawl screw	.45
66	E37-7201	Anti-reverse pawl spring B	1.65
67	E41-8601	Drive gear	3.90
68	373-7803	Drive gear washer	.40
69	631-6901	Ball bearing B	6.85
70	F10-9501	Side cover	6.90
71	E15-8602	Side cover screw	.60
73	E41-8701	Handle assembly	8.75
74	F02-0201	Handle lock washer	.35
75	F03-5601	Handle lock screw	1.65
76	F15-6501	Drag screw collar	1.10